

**IMPORTANT**  
Read and understand this entire manual carefully before assembling or using this stove. Keep this manual for future reference. If you do not understand this manual or have any questions, please call Cascade Designs, Inc. at 1-800-531-9531.

- Never use this stove in an enclosed space such as a camper, tent, vestible, car, or home.
- Using it in an enclosed space can kill you.
- This stove can produce carbon monoxide, which has no odor.

**CARBON MONOXIDE HAZARD**



**! DANGER**

**INSTRUCTION MANUAL**



**WINDPRO™ II STOVE**

Retain these instructions for future reference.

**FOR YOUR SAFETY**

**Do not store or use gasoline or other liquids with flammable vapors in the vicinity of this or any other stove.**

**FOR YOUR SAFETY**

**If you smell gas:**

1. Do not attempt to light stove.
2. Extinguish any open flame.
3. Disconnect stove from fuel canister.

**! WARNING**

DO NOT USE THIS STOVE (1) before you read and fully understand this Instruction Manual, (2) if you are not comfortable or prepared to operate a burning or hot stove at all times, (3) if you observe leaking fuel, or (4) if you observe any condition with the stove system or in the surrounding environment that would result in the dangerous operation of an open-flamed device. Failure to follow these directions can cause an unsafe situation and lead to fire, burns, severe injury or death.

This stove is designed for the outside (not within enclosed spaces of any kind, e.g., tents) and for the boiling of water or cooking of food only—never use it for any other purpose. Use of stove within any enclosed space or for a purpose other than boiling water or cooking food can cause fire, burns, severe injury or death.

Do not disassemble stove beyond what is described in these instructions. Do not modify stove. Disassembly or modification of stove in any manner not consistent with these instructions voids warranty and can result in an unsafe situation where fire, burns, severe injury or death can occur.

Do not use stove if parts are missing or broken, or with replacement parts not specific to your stove model. Use of stove with missing or broken parts, or with replacement parts not specific to your stove model, can result in an unsafe situation where fire, burns, severe injury or death can occur.

Always use stove on a solid, stable, even surface to avoid tipping and spills. Tipping of stove can result in an unsafe situation where fire, burns or severe injury or death can occur.

Cascade Designs, Inc. warrants the use of appropriately sized MSR® brand cookware only—use of cookware other than MSR® brand cookware will be at user's own risk and discretion.



MOUNTAIN SAFETY RESEARCH®

For product service and information contact  
**Cascade Designs, Inc.**  
4000 First Avenue South, Seattle, WA 98134 USA  
1-800-531-9531 or 206-505-9500  
www.msrgear.com



Printed on recycled paper containing 30% post-consumer waste.

ART# 33-362 | EN

**LIMITED WARRANTY/LIMITATIONS OF REMEDIES AND LIABILITY**  
**USA and Canada**

**Limited Warranty.** Cascade Designs, Inc. ("Cascade"), to the original owner ("Owner"), under intended use and maintenance, warrants the enclosed product ("Product") to be free from defects in materials and workmanship for the life of the Product. No warranty against defects in materials and workmanship will apply if Product is (i) altered in any way, (ii) used for purposes inconsistent with Product's intended purpose or design, or (iii) improperly maintained. Warranty will further more be voided where Owner/user (i) failed to follow Product instructions or warnings or (ii) subjected Product to misuse, abuse, or neglect.

During the warranty period, original Product parts determined by Cascade to be defective in materials or workmanship will be repaired or replaced as Owner's sole remedy. Cascade reserves the right to replace any discontinued product with a new product of comparable value and function. A returned product deemed irreparable becomes the property of Cascade and will not be returned.

EXCLUDING THE LIMITED WARRANTY PROVIDED ABOVE, CASCADE, ITS AFFILIATES AND THEIR SUPPLIERS, TO THE MAXIMUM EXTENT PERMITTED BY LAW, MAKE NO WARRANTIES, EXPRESSED OR IMPLIED, AND DISCLAIM ALL WARRANTIES, DUTIES AND CONDITIONS, WHETHER EXPRESSED, IMPLIED OR STATUTORY WITH RESPECT TO THE PRODUCT, INCLUDING WITHOUT LIMITATION ANY IMPLIED WARRANTIES OF MERCHANTABILITY, AGAINST LATENT DEFECTS, FITNESS FOR A PARTICULAR PURPOSE, OR CORRESPONDENCE TO DESCRIPTION.

Warranty Service. To obtain service under this warranty, the warranty-eligible Product must be presented to a Cascade authorized dealer. In the United States and Canada, warranty service may also be obtained by calling 1-800-531-9531 [MF, 8:00-4:30, PDT].

**! DANGER**

**CARBON MONOXIDE, FIRE & EXPLOSION HAZARD**

There are serious hazards associated with using this stove and fuel. Accidental fire, explosion, and misuse can cause death, serious burns, and property damage. You are responsible for your own safety and the safety of those in your group. Please use good judgment.

This stove is for OUTDOOR USE ONLY. Never use this stove in a tent, vestible, car, house, or inside any enclosed area. This stove consumes oxygen and produces carbon monoxide gas, which is poisonous and has no odor. This stove can easily ignite nearby combustible materials and flammable liquids or vapors. If you use this stove in an enclosed area you can be killed or seriously burned.

Keep stove and canister away from other heat sources. Never use cookware or an Outback Oven™ with a diameter larger than 10 inches (25 centimeters). Oversized cookware can overheat the fuel canister. If you expose the canister to high heat, it will explode and you can be killed or seriously burned.

Never let children use this stove. Keep children at least 10 feet (3+ meters) away from the stove and cooking area and supervise them at all times.

READ, UNDERSTAND, AND FOLLOW ALL instructions and warnings in this manual before using this stove. Failure to follow warnings and instructions can result in death, serious burns or other injury, and property damage.

Owner is responsible for all costs associated with returning Product to Cascade for service. Where at its sole discretion Cascade deems Product eligible for warranty repair or replacement, Cascade will pay the shipping and handling associated with returning repaired or replaced Product to Owner. In instances where Cascade deems a returned product ineligible for warranty service, Cascade will, if possible, repair product for a reasonable fee that includes return shipping and handling. For warranty return service details, please go to [www.msrgear.com](http://www.msrgear.com).

Limitation of Remedies. Should a court of competent jurisdiction find the limited warranty set forth above breached, Cascade's only obligation will be, at its option, either to repair or replace Product. Should the aforementioned remedy fail of its essential purpose, Cascade will, in exchange for return of Product, refund to Owner the Product's original purchase price. THE FOREGOING REMEDY IS THE SOLE AND EXCLUSIVE REMEDY OF THE PURCHASER AGAINST CASCADE, ITS AFFILIATES AND THEIR SUPPLIERS, REGARDLESS OF LEGAL THEORY.



Limitation of Liability. Cascade, its affiliates and their suppliers' maximum liability is limited to incidental damages not to exceed the original purchase price of the Product. ANY LIABILITY FOR ANY CONSEQUENTIAL OR OTHER DAMAGES RESULTING FROM CASCADE, ITS AFFILIATES AND THEIR SUPPLIERS HEREBY DISCLAIM AND EXCLUDE AND THEIR SUPPLIERS, TO THE MAXIMUM EXTENT PERMITTED BY LAW, MAKE NO WARRANTIES, EXPRESSED OR IMPLIED, AND DISCLAIM ALL WARRANTIES, DUTIES AND CONDITIONS, WHETHER EXPRESSED, IMPLIED OR STATUTORY WITH RESPECT TO THE PRODUCT, INCLUDING WITHOUT LIMITATION ANY IMPLIED WARRANTIES OF MERCHANTABILITY, AGAINST LATENT DEFECTS, FITNESS FOR A PARTICULAR PURPOSE, OR CORRESPONDENCE TO DESCRIPTION.

Warranty Service. To obtain service under this warranty, the warranty-eligible Product must be presented to a Cascade authorized dealer. In the United States and Canada, warranty service may also be obtained by calling 1-800-531-9531 [MF, 8:00-4:30, PDT].

Always completely follow safety, use, operation, and maintenance instructions for this or any other Cascade product.

European Union customer statutory rights are not affected.

**FOR OUTDOOR USE ONLY**

**Nominal Heat Input Rate:**  
7,450 BTU/h  
10,000 BTU/h (liquid feed mode)



2009/142/EC  
(51802370-2011)  
CATEGORY: VAPOR PRESSURE  
BUTANE PROPANE

**Nominal Heat Input Rate:**  
3.2 kW  
230 g/h

Stove Orifice Size: 0.34 mm

NOTE: Nominal Heat Input Rate varies depending on test procedures of the particular standards agency.

# GENERAL SAFETY INFORMATION

To avoid being killed or seriously injured, READ, UNDERSTAND, AND FOLLOW ALL warnings and instructions in this manual before you use this stove.

This stove is a lightweight, compact device made for cooking outdoors. Please consult with your local outdoor retailer to learn more about cooking outdoors. Seek qualified instruction before you venture outdoors.

You are responsible for your own safety and the safety of those in your group. This manual is not intended to replace your good judgment.

## Fuel Canister Safety

This stove uses a liquid pressurized gas (LPG) canister that is highly flammable and explosive. Use only MSR® premium blend canister fuel, 70 Butane/30 Propane or 80 IsoButane/20 Propane mix, certified to EN 417 (4 ounces/113 grams or 8 ounces/227 grams). Do not attempt to fit other types of gas canisters. For any fuel canister, follow this safety information:

- Listen and smell for leaking gas. Leaking gas is a serious hazard. LPG is invisible and odorless, and strong odorant additives can fade over time. Leaks are not always detectable by smell. Do not use this stove if it is leaking or damaged, or it does not operate properly.
- Check that the stove and fuel canister connection is secure and tight. If the connection does not look or feel secure or you hear or smell leaking gas, do not use stove or canister. Move stove to a well-ventilated area away from any ignition source to locate and stop the leak. Only check for leaks outdoors using soapy water. Do not try to detect leaks using a flame.
- Only change the canister outside and away from people and any source of ignition.
- Never use fuel canisters larger than 8 ounces (227 grams) or more than 4 inches (10 centimeters) in height, because oversized canisters decrease stove stability.
- Check the seals before connecting a new fuel canister to the stove. Do not use stove if seals are damaged or worn.
- Keep stove and fuel canister away from other heat sources. If you expose the fuel canister to high heat, the canister will explode or leak and you can be killed or seriously burned.
- Follow all warnings on fuel canister regarding use and storage.

# KNOW YOUR MSR® WINDPRO™ II STOVE

Please familiarize yourself with the parts of your WindPro II stove and the following instructions before connecting the stove to its fuel canister. Never use this stove in any other way than is described in the following instructions.

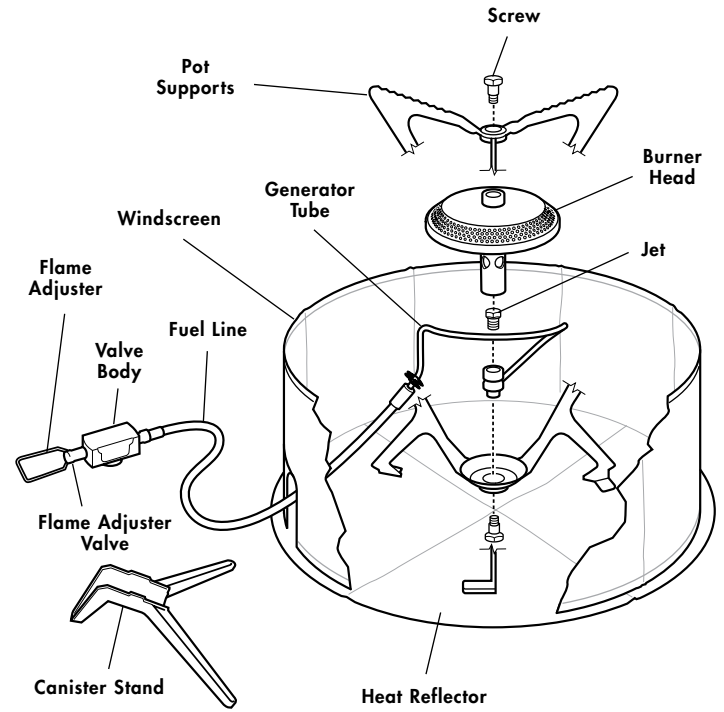

# WINDPRO™ II STOVE OPERATING INSTRUCTIONS

## 1 CONNECT STOVE AND CANISTER

1. **Unfold Flame Adjuster.**
2. **Close Flame Adjuster Valve.**
3. **Finger-tighten canister onto stove Valve Body until connection is secure.**

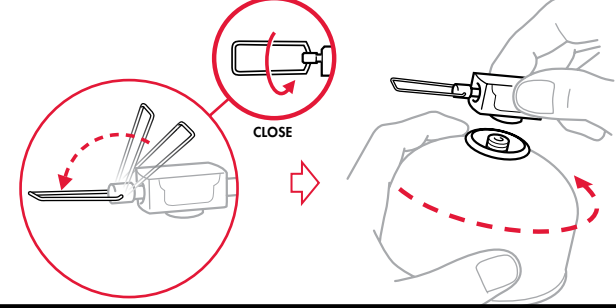

### WARNING

Never overtighten fuel canister to stove. Overtightening can damage stove or canister and cause fuel to leak. Leaking fuel can cause fire, burns, severe injury or death. The canister must be constructed and marked in accordance with the CAN/CSA 339.

Use extreme caution when using stove in temperatures below freezing. In freezing temperatures O-rings can stiffen and leak fuel. Always check for fuel leaks before and after lighting stove. Use of a leaking stove can cause fire, burns, severe injury or death.

Keep children far away from stove and fuel—Cascade Designs, Inc. recommends no less than 10 feet (3+ meters). Never leave a burning or hot stove unattended. An unattended stove can lead to fire and/or a situation where children, pets, or the unwary can be burned, injured, or killed.

## 2 SET UP STOVE

1. **Clear cooking area of combustible materials and flammable liquids or vapors.**
2. **Place stove assembly on a solid, stable, even surface to ensure stability.**
3. **Rotate Pot Supports/Legs fully open.**
4. **Place stove on the center of Heat Reflector.**

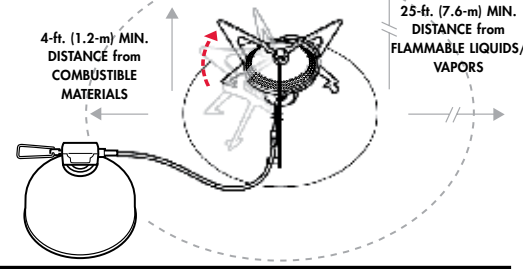

### WARNING

Keep combustibles at least 4 feet (1.2 meters) away from the top and sides of a burning stove, or a stove that you are in the process of lighting. Keep flammable liquids and vapors at least 25 feet (7.6 meters) away from the top and sides of a burning stove, or a stove that you are in the process of lighting. This stove can ignite combustible materials, flammable liquids and vapors and create a situation where fire, burns, severe injury or death can result.

Keep fuel canister away from the stove burner and other heat sources. Position connected fuel canister so that it is as far away from the burner as possible. Use of canister near burner or other heat sources can result in the canister exploding and causing fire, burns, severe injury or death.

Never attempt to light stove if Flame Adjuster Valve is left open. If Flame Adjuster Valve is left open, close it immediately and thoroughly ventilate area before lighting stove. Failure to ventilate area can result in an explosion that can cause fire, burns, severe injury or death.

## 3 TURN STOVE ON

**IMPORTANT:** Always start stove with fuel canister in upright position to prevent a large flare-up. A proper flame will appear blue.

### VAPOR FEED MODE (MOST CONDITIONS, BEST SIMMERING)

1. **Hold a lit match or lighter over the edge of Burner Head.**
2. **Open Flame Adjuster Valve (3/4 turn) to release and ignite fuel.**
3. **Turn Flame Adjuster Valve to produce and maintain steady flame.**

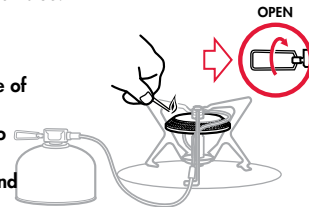

### LIQUID FEED MODE (VERY COLD CONDITIONS OR HIGHER OUTPUT/FASTER BOILING)

1. **Attach Canister Stand onto top of Valve Body.**
2. **Hold a lit match or lighter over the edge of Burner Head.**
3. **Open Flame Adjuster Valve (3/4 turn) to release and ignite fuel.**  
Allow fuel to burn for 30 seconds to ensure stove is properly primed.
4. **Invert Fuel Canister, using Canister Stand to support it.**
5. **Turn Flame Adjuster Valve to produce and maintain steady flame.**

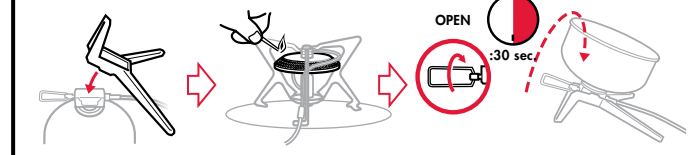

### WARNING

Never place your head or body above the stove while lighting or cooking. Because stove maintains an open flame, placement of head or body above stove is an unsafe practice that can cause fire, burns, severe injury or death.

## 4 USE STOVE TO COOK

1. **Set up Windscreen.**  
Fold ends of Windscreen together. Leave a 1-inch (2.5 cm) gap between Windscreen and cookware for optimal performance. Ensure that combustion flow and ventilation air are free of any obstruction. Use Windscreen to improve performance in all conditions.
2. **Add appropriate food or liquid to cookware.**
3. **Place cookware onto the center of the stove.**
4. **Turn Flame Adjuster Valve to adjust heat.**

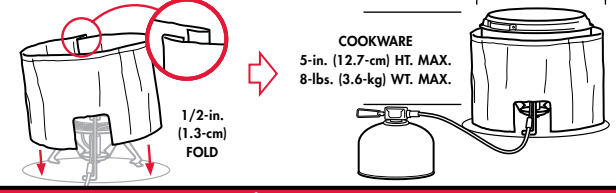

### WARNING

Never move a burning or hot stove. Always extinguish stove and cool for at least 5 minutes before moving. Moving a burning or hot stove can cause fire, burns, severe injury or death. Never use cookware with a diameter greater than 10 inches (25 centimeters). Never place and operate two or more stoves together. Never operate stove with empty or dry cookware. Never use non-MSR® reflectors or diffusers. Use of stove in any of the preceding manners can result in the fuel canister exploding and causing fire, burns, severe injury or death. Never use cookware of any size that is ill-suited and/or inappropriate for use with stove, particularly its pot supports (e.g., cookware with a convex or concave bottom, some enameled cookware, etc.). Use of stove with ill-suited and/or inappropriate cookware can result in cookware and/or stove instability and a situation where hot cookware and/or cookware contents can spill and cause fire, burns, severe injury or death.

## 5 TURN STOVE OFF

1. **Place the fuel canister in an upright position if inverted.**
2. **Close Flame Adjuster Valve when cooking is done.**  
Residual fuel will continue to burn with a small flame.
3. **After flames are out, wait 5 minutes for stove to cool.**  
Remove Canister Stand if attached.  
Fold Flame Adjuster.
4. **Ensure that flames are extinguished.**  
Fold Pot Supports.
5. **Move stove assembly away from any ignition sources and unscrew canister.**  
A small amount of gas may escape when unscrewing canister.

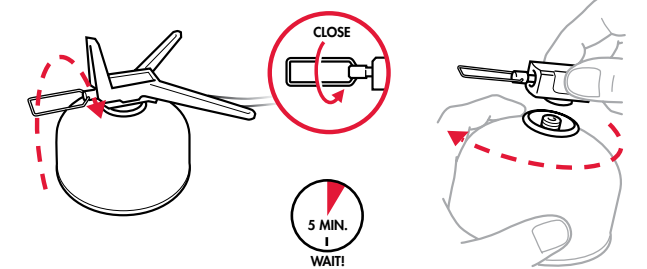

### WARNING

Always disconnect stove from canister before storing it. Failure to disconnect stove from canister before storing may cause fuel to leak and cause fire, burns, severe injury or death. Always store fuel canisters in a well-ventilated location away from any possible heat or ignition source, such as water heaters, stoves, pilot lights, or furnaces, or where temperatures exceed 120 F (49 C). Storing fuel canisters near any heat or ignition source or where temperatures exceed 120 F (49 C) can result in the canister exploding and causing fire, burns, severe injury or death.

## TROUBLESHOOTING

Problem	Poor Performance	Cause	Solution
Stove flares with inverted canister	Stove flares with inverted canister	Insufficiently preheated stove	Run stove with upright canister 30 seconds - then invert canister
Diminished flames	Diminished flames	Low fuel Cold canister	Replace canister Swap canister
Stove does not light	Stove does not light	Cold canister Windy conditions	Swap canisters Use Windscreen
		Empty canister*	Replace canister
Poor flame control	Poor flame control	Inverted fuel canister	Place canister in upright position for optimal flame control

\*To check if canister is empty, remove stove and gently shake canister. If a splashing sound is heard, canister still contains fuel.

Stove service must only be done by an individual authorized by Cascade Designs, Inc. If you have any questions about these instructions, your stove, replacement parts, or repairs, please contact:  
 Cascade Designs, Inc., USA - **1-800-531-9531 or 206-505-9500**  
 Cascade Designs, Ltd., Ireland - **(+353) 21-4621400**  
 www.msrgear.com info@cascadedesigns.com